

City Hall Entry Improvements

Economic Development and Housing Committee – June 4, 2007



Purpose

- Review recommendations for improving City Hall as funded in FY 2006-07
 - \$275,000 to make entry more welcoming for visitors and dignitaries
 - \$105,000 to address security concerns for ground level doors
- Obtain committee approval to proceed

Enhance Entry

- Countless visitors come to City Hall each year
- Building is grand in appearance but offers no sense of individual invitation
- Improvements can be made to provide a more welcoming experience for visitors, officials, and dignitaries
 - 1. Replace temporary barricades at each end of Marilla with permanent gates
 - 2. Add signage to “welcome” visitors to City Hall
 - 3. Designate L1-Green entrance as primary access point for visitors and officials at garage level

1. Gates for Marilla

- Marilla is closed to through traffic and only open for special events
- Current street closure barricades are not aesthetically pleasing
- Permanent gates designed to match existing concrete railing on plaza are recommended for each end of Marilla
 - Metal truss with glass fiber reinforced concrete enclosure
 - Expected cost - \$60,000



Photo – example of concrete railing on plaza

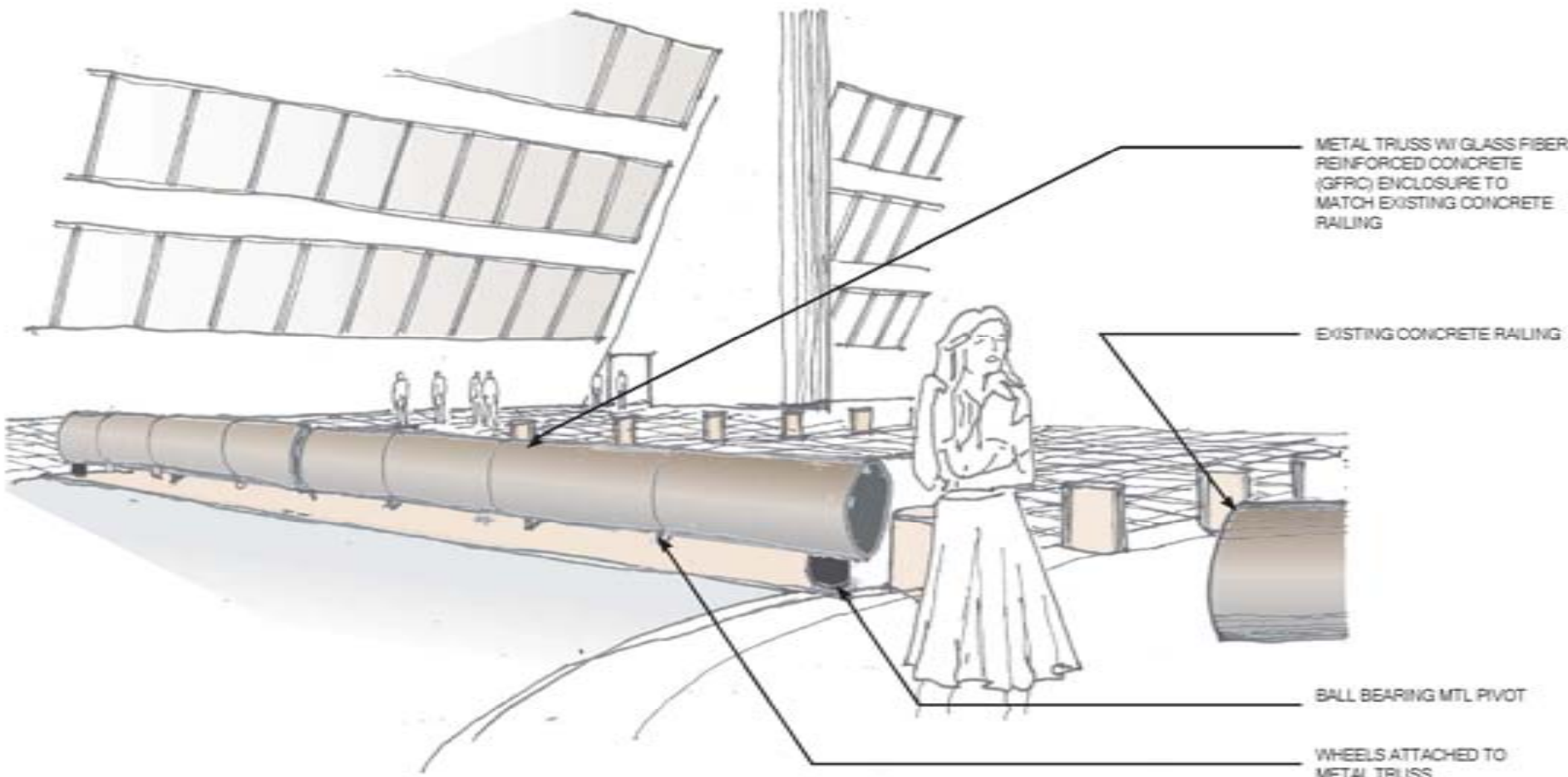

Proposed gates for each end of Marilla

GATE @ MAIN PLAZA

GATE
Dallas City Hall Renovation
Dallas, Texas

July 2010
Rationale: Preliminary
Date: 02/10/17
Drawing: UIC

Good Falton & Farrell Architects
 1000 Ross Avenue, Suite 1000, Dallas, Texas 75202
 214.760.1000

2. Signage

- City Hall building does not extend personal or individualized welcome to visitors
- Welcome signage is recommended for installation at two key entrances to building
 - At main entrance into garage
 - Inside main lobby
- Visitors and officials primarily enter garage at Young street
 - LED signage/message board recommended for installation above garage entrance
 - Provide messages via text only
 - Expected cost - \$45,000



Photo – garage entrance at Young Street

2. Signage (continued)

- Visitors and officials also enter building through Main Lobby
 - Digital signboard with multi-functional capabilities recommended for installation in Main Lobby
 - System should allow for greatest programming flexibility
 - Video (example: “Dallas Delivers”)
 - Text messages (examples: welcome dignitaries to City; identify meeting locations i.e. Council Briefing in 6E-South; announce City/community events i.e. Mayor Back to School Fair; announce City messages i.e. customer service tip, ozone day, etc.)
 - Still image (example: loop of still photos i.e. display of Public Art throughout city)
 - Enhance special events (example: special programming i.e. use during Unsung Hero recognition)
 - Installation options
 - Free standing on lobby floor
 - Wall mounted – consider directly across from Main Entrance and mounted on side of second floor walkway/bridge
 - One signboard option - DIOBOSS viewed recently by City delegation on international visit
 - 46”, 57”, and 82” freestanding options available (cost \$3,500 to \$35,000)
 - Expected cost - \$55,000



Photo – possible location for signboard in Lobby 10

3. L1-Green Entrance

- Develop one primary access point into building from garage for visitors and officials
- Current visitor and official parking
 - Visitors currently enter from Young Street and park on L1 in close proximity to garage entry/exit and near Green doors
 - Council and boards/commissions parking currently on L2
- L1-Green entrance recommended as the one primary entrance
 - L1 direct access from Young Street entrance/exit ramp
 - L1 parking attendant booth in close proximity to parking
 - Parking attendant booth to L1 Row R is about 175 ft.
 - Parking attendant booth to L2 Row R is about 475 ft.
 - L1 auditorium and conference rooms used for special events and after hours
 - L1 parking has pedestrian exit directly onto plaza if necessary for events
 - L1 Green elevator area is open to Lobby area above
- Relocate council and boards/commission parking to L1
- Relocate security dispatch from L1-Blue to L1-Green and incorporate as part of main access point from garage into building
 - After completion of fire alarm installation (bond sell Nov 2009)

3. L1-Green Entrance (continued)

- Develop L1-Green as primary access point from garage into building
 - Improve facade by finishing out concrete with stucco
 - Improve lighting
 - Add digital signboard
 - Add pedestrian safety features
 - Expected cost - \$60,000

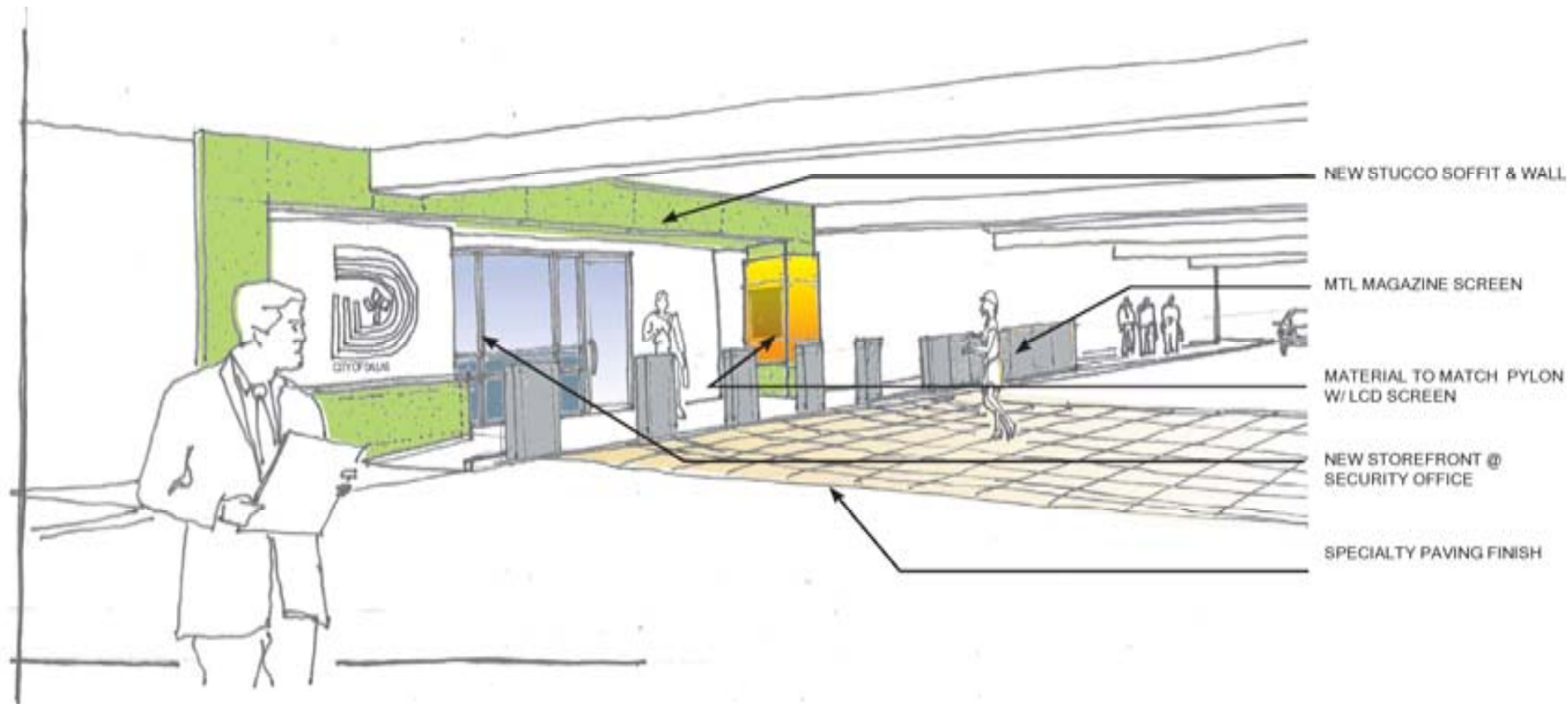

Proposed improvements for L1-Green

OPTION 2

L1 ENTRY

Dallas City Hall Renovation
Dallas, Texas

Job #: 07510
File Name: Preliminary.rvt
Date: 02/19/07
Drawn by: LKO



Good Fulton & Farrell Architects

2000 Ross Street
Dallas, TX 75201
Phone: 214.742.1000
www.gff.com

Ground Level Doors

- \$105,000 to address security concerns for ground level doors
 - Currently unable to lock or unlock glass doors automatically
 - Currently unable to use glass doors as emergency egress via panic hardware
- Options researched to replace doors or retrofit existing doors
 - Research by consultant identified doors available through original vendor
 - Cost to replace doors is \$12,000 per door for 26 ground level doors (\$312,000)
 - Seeking solution to retrofit doors with safety hardware

Summary

Improvement	Budget	Improvement	Expected Cost
Enhance entry for visitors and dignitaries	\$275,000	Consultant	\$25,000
		Gates for Marilla	\$60,000
		LED signage for Young Street entrance to garage	\$45,000
		Digital signboard for Main Lobby	\$55,000
		L1-Green Entrance	\$60,000
		Total	\$245,000
Ground level doors – safety hardware	\$105,000	Ground level doors – safety hardware	\$135,000

Summary

- Obtain committee approval to proceed
- Request for Bid to be advertised for design/build construction project
- Seek City Council authorization in August 2007
- Complete project by end of December 2007